

4" SUBMERSIBLE MOTORS

4PD



Description

NEMA standard
 Speed: 2850rpm
 Insulation class: B
 Protection grade: IP 68
 Highest temperature of liquid: 35°C
 Maximum content of solid substance: 40g/m³
 Flange and coupling according to NEMA standard
 Motor casing: stainless steel
 Maximum diameter: $\Phi 98$ mm

With sandproof cover / pressure balance membrane/mechanical seal with high performance.

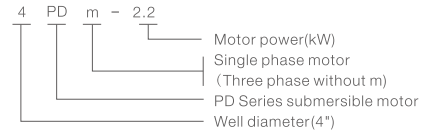

Single phase motor technical data:

MODEL	MOTOR POWER		CAPACITOR 450V μF	CURRENT RATED A	EFFICIENCY % η	POWER FACTOR Cos ϕ
	kW	HP				
Single phase 220-240V ~ 50Hz						
4PDm-0.25	0.25	0.33	16.5	2.8	54	0.93
4PDm-0.37	0.37	0.5	20	3.9	55	0.93
4PDm-0.55	0.55	0.75	25	5.2	58	0.93
4PDm-0.75	0.75	1	30	7	61	0.93
4PDm-0.9	0.9	1.2	35	8.1	63	0.93
4PDm-1.1	1.1	1.5	40	9.1	64	0.93
4PDm-1.5	1.5	2	50	11.2	67	0.93
4PDm-2.2	2.2	3	70	16.4	68	0.93
4PDm-3	3	4	80	20.8	68	0.93
4PDm-4	4	5.5	120	26	67	0.93

Wiring diagram of motor

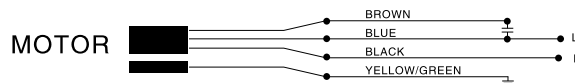

Each single phase three wires motor should equip a control box

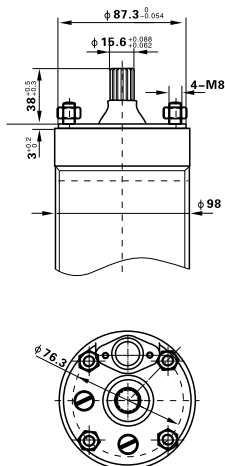

Three phase motor technical data:

MODEL	MOTOR POWER		CURRENT RATED A	EFFICIENCY % η	POWER FACTOR Cos ϕ
	kW	HP			
Three phase 380-415V ~ 50Hz					
4PD-1.1	1.1	1.5	3.0	66	0.74
4PD-1.5	1.5	2	3.9	68	0.76
4PD-2.2	2.2	3	5.5	70	0.77
4PD-3	3	4	7.3	71	0.77
4PD-4	4	5.5	9.6	74.5	0.78
4PD-5.5	5.5	7.5	13.7	75.5	0.79
4PD-7.5	7.5	10	18.8	76	0.80

6" SUBMERSIBLE MOTORS 6PA



Description

NEMA standard
 Speed: 2850rpm
 Insulation class: F
 Protection grade: IP 68
 Highest temperature of liquid: 35°C
 Maximum content of solid substance: 40gr/m3
 Flange and coupling according to NEMA standard

With sandproof cover / pressure balance membrane/mechanical seal with high performance.

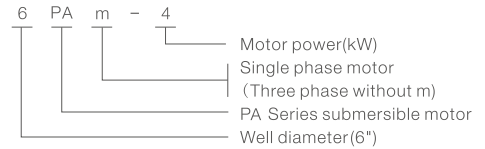

Single phase motor technical data:

MODEL	MOTOR POWER		CAPACITOR 450V μ F	CURRENT RATED A	EFFICIENCY % η	POWER FACTOR Cos φ
	kW	HP				
Single phase 220-240V ~ 50Hz						
6PAm-3	3	4	90	18.4	68	0.93
6PAm-4	4	5.5	130	22.8	69	0.93
6PAm-5.5	5.5	7.5	160	34.6	70	0.93
6PAm-7.5	7.5	10	160	47.9	71	0.93

Wiring diagram of motor

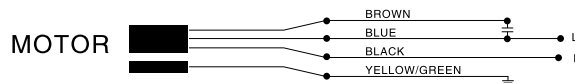

Each single phase three wires motor should equip a control box

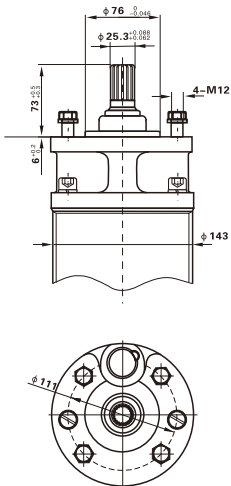

Three phase motor technical data:

MODEL	MOTOR POWER		CURRENT RATED A	EFFICIENCY % η	POWER FACTOR Cos φ
	kW	HP			
Three phase 380-415V ~ 50Hz					
6PA-3	3	4	7.4	75	0.76
6PA-4	4	5.5	9.7	76	0.78
6PA-5.5	5.5	7.5	13.1	75	0.83
6PA-7.5	7.5	10	17.2	76	0.84
6PA-9.2	9.2	12.5	20.1	78	0.84
6PA-11	11	15	24.7	78	0.85
6PA-13	13	17.5	28.8	80	0.84
6PA-15	15	20	32.7	81	0.85
6PA-18.5	18.5	25	40.4	81	0.84
6PA-22	22	30	47.6	83	0.84